

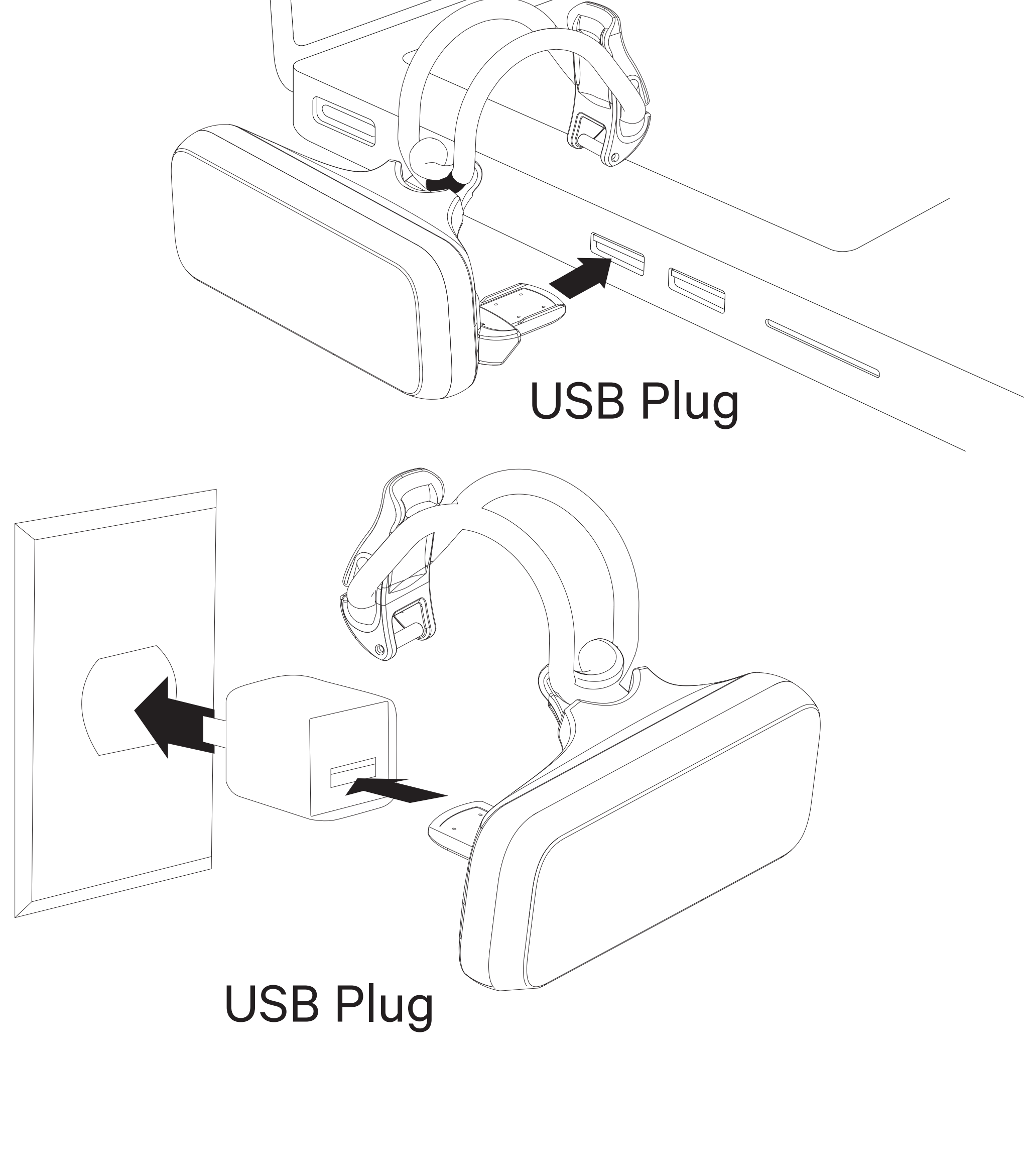

BLINDER V

QUICK START GUIDE

RECHARGE BEFORE USE



INTERFACE

A B C

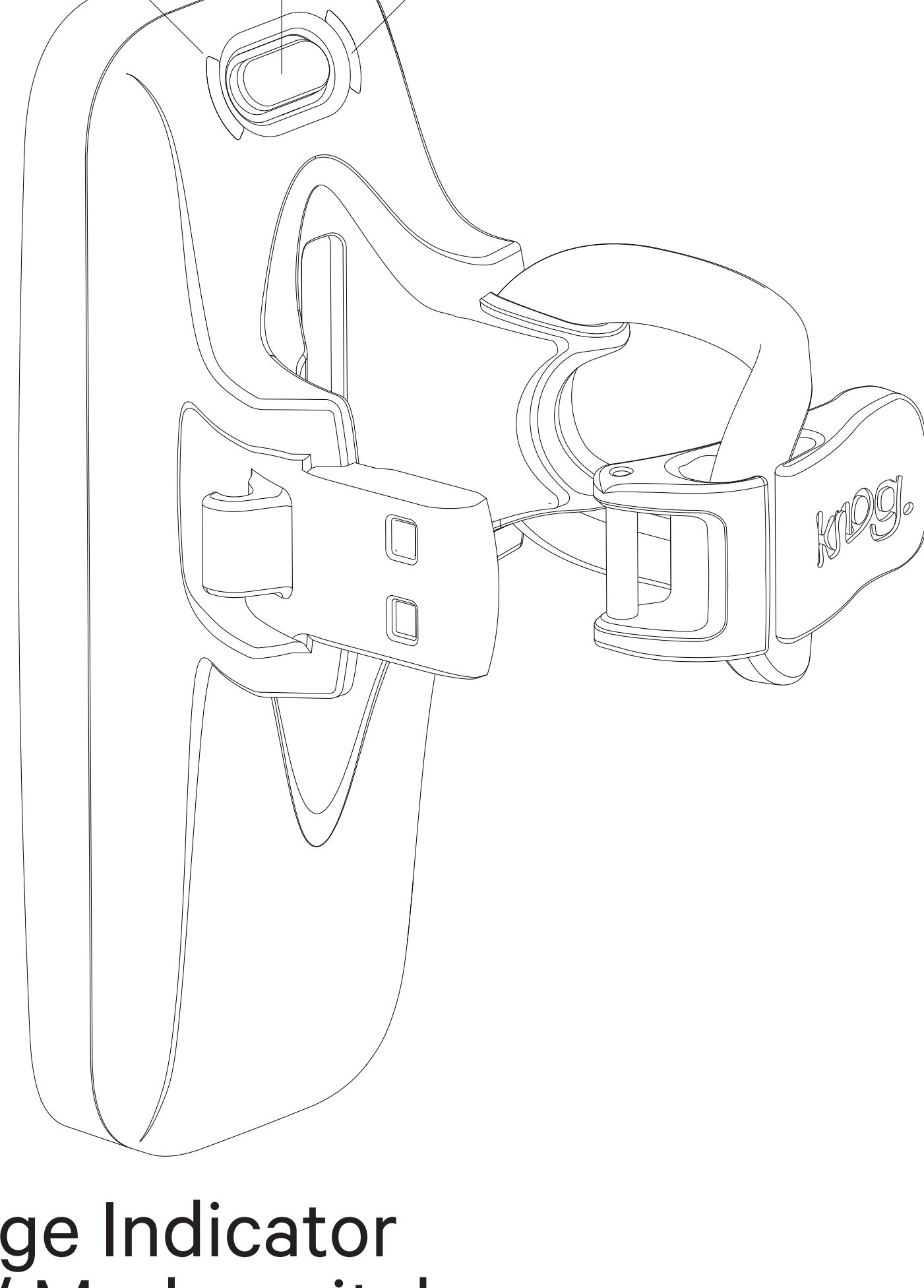

A. Recharge Indicator
 B. Power / Mode switch
 C. Low Battery Indicator

Long press B to turn light on and off.
 Short press B to cycle between modes.

FITMENT

3 STRAP SIZES INCLUDED

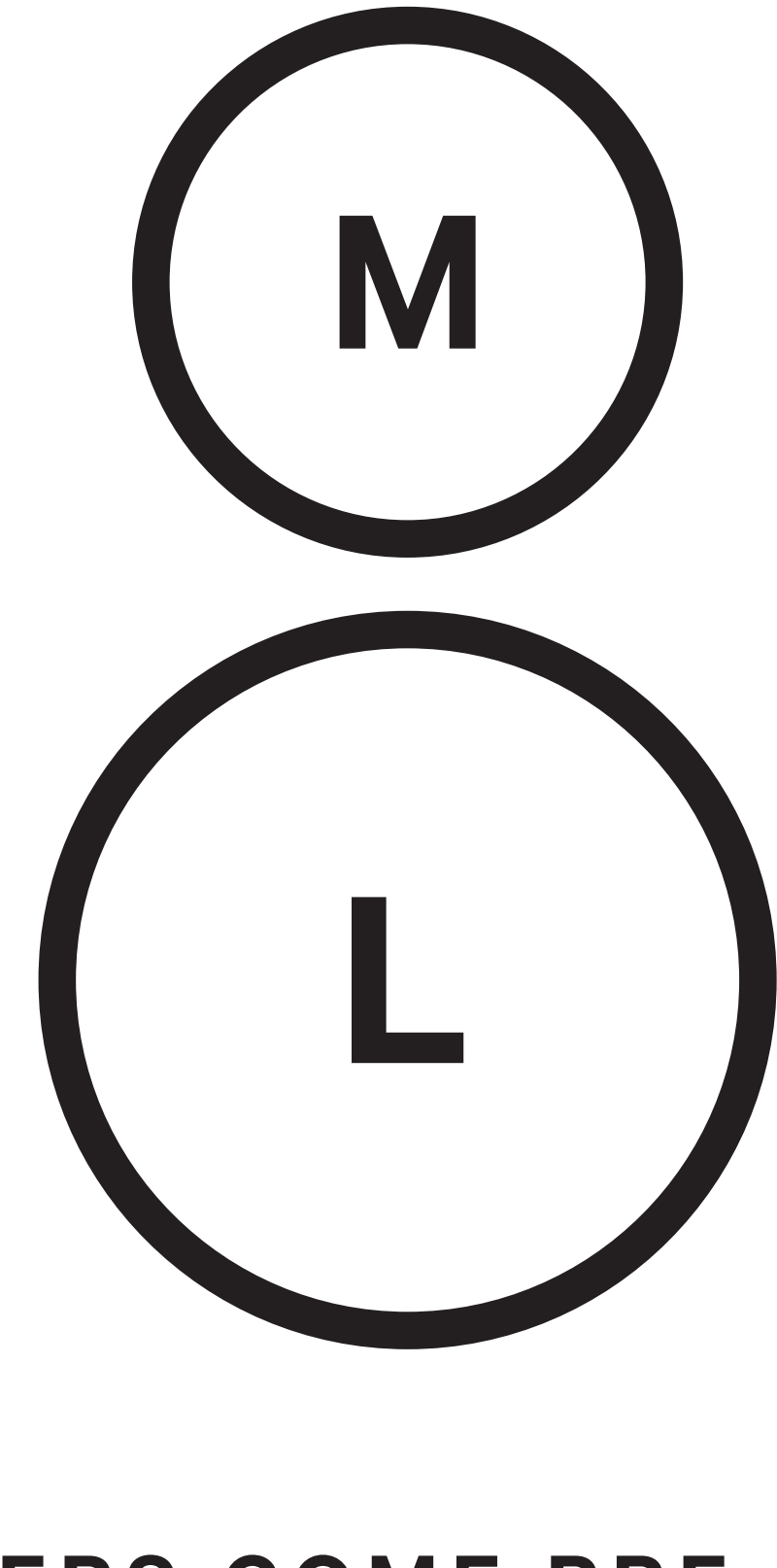

BLINDERS COME PRE-FITTED TO CLASP WITH MEDIUM STRAP

INTERCHANGEABLE STRAP

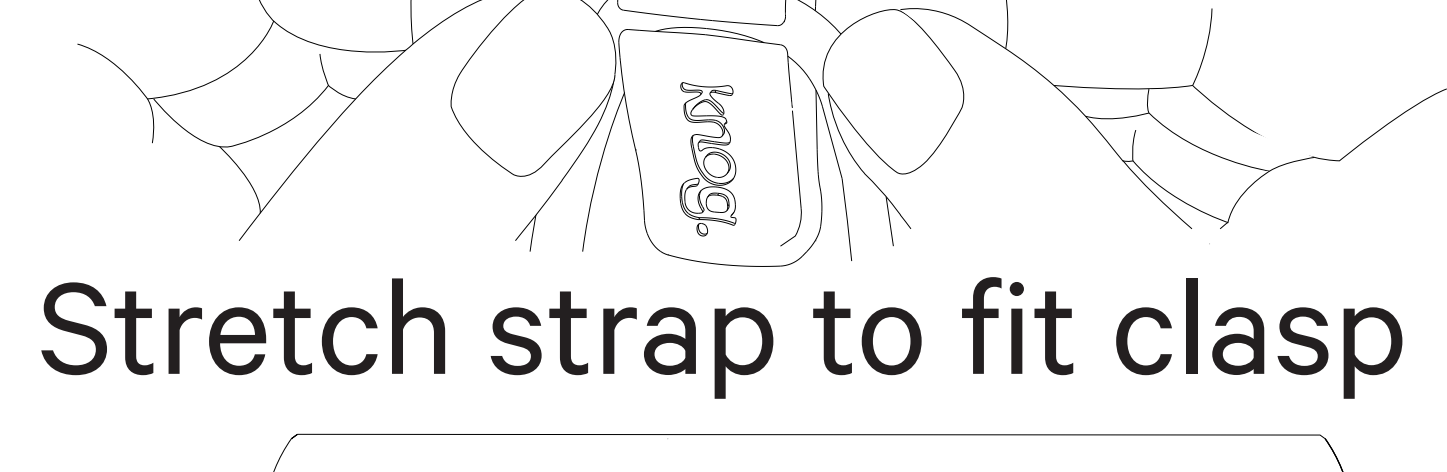

Stretch strap to fit clasp

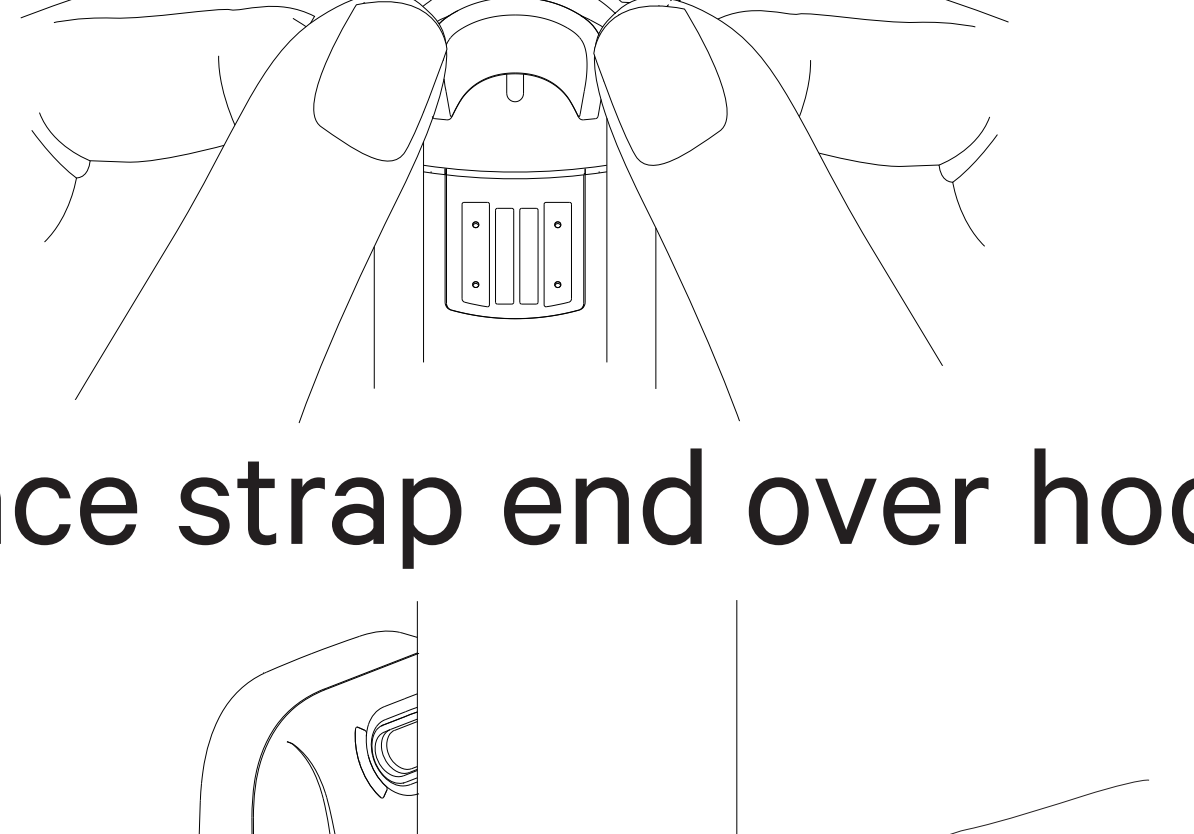

Place strap end over hook



Pull strap toward the light body

MOUNTING

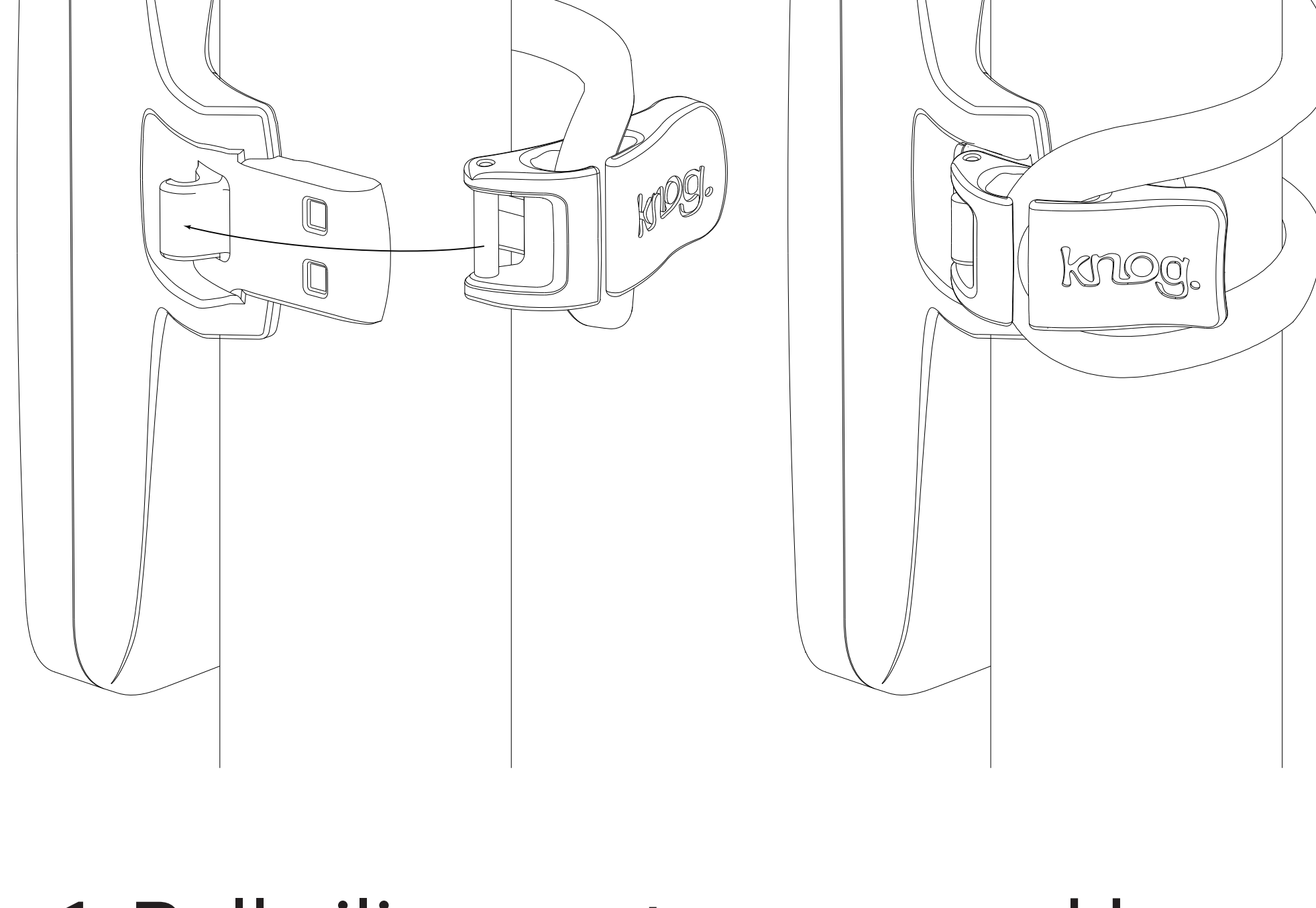

1. Pull silicone strap around bar
2. Engage latch into hook

THE RANGE

BOLT

TRAFFIC

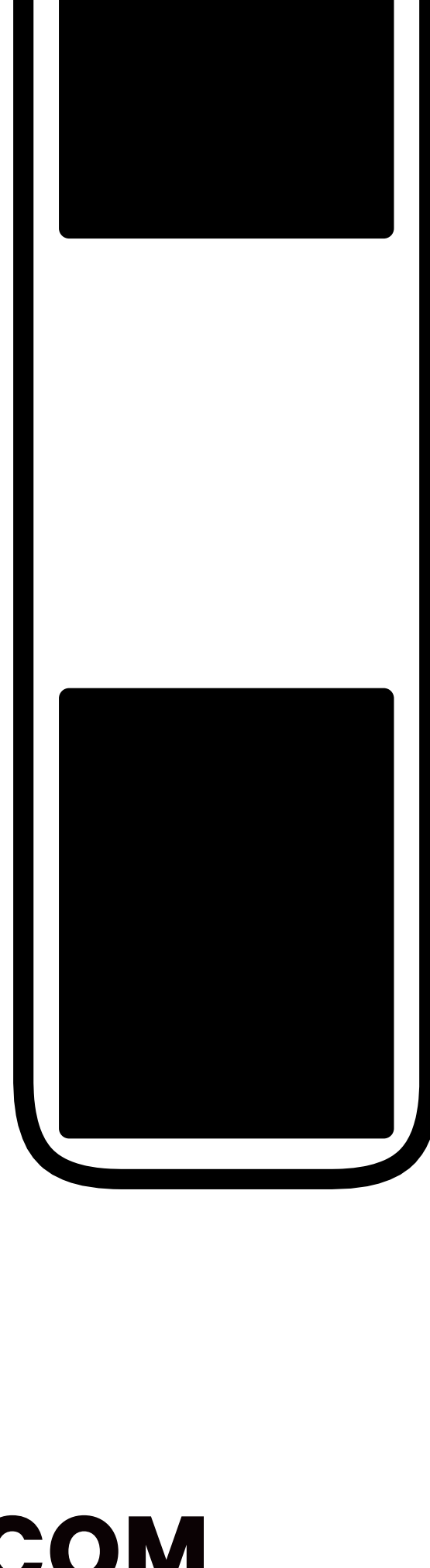
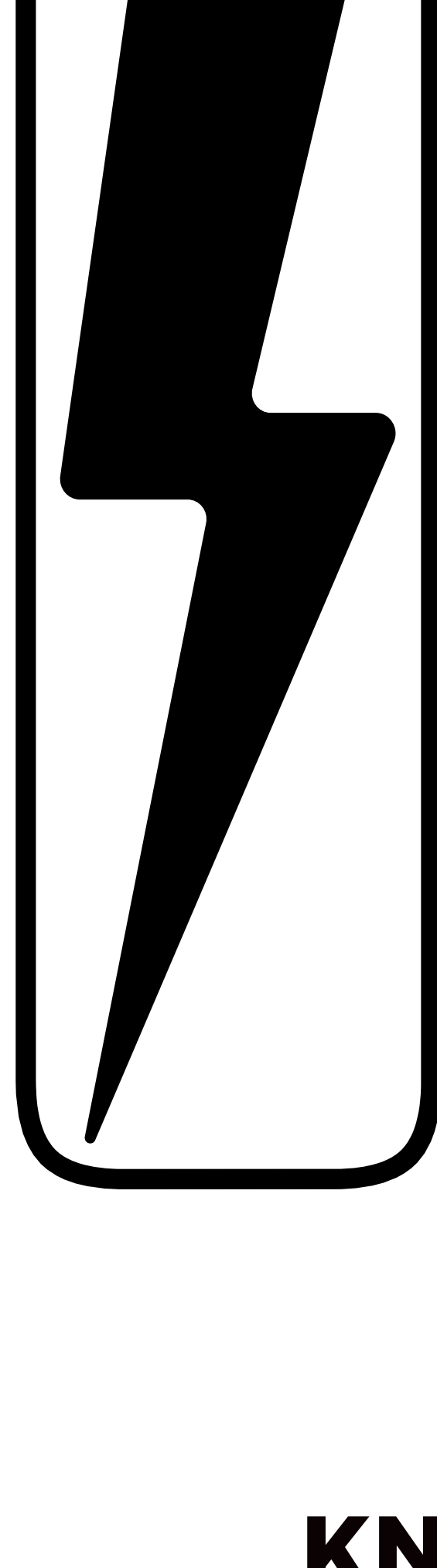

KNOG.COM

WARRANTY INFORMATION

This light is guaranteed for 2 years against manufacturing defects only.

The battery is guaranteed for 6 months against manufacturing defects only. See the website for more details.

For more information go to

KNOG.COM